

ACCESSIBILITY

Directly connected to Quarry Bay MTR Station

TYPICAL LETTABLE FLOOR AREA

Approx. 6,800 - 7,100 sq ft (630 - 660 sqm)

NO. OF OFFICE FLOORS

33

TYPICAL FINISHED FLOOR TO FALSE CEILING HEIGHT

Approx. 2.8 m (9 ft 3 in)

RAISED FLOOR VOID (CLEAR)

Approx. 150 mm (6 in)

FLOOR LOADING

Approx. 4 kPa (80 lbs / sq ft)

TRUNKING

Three-compartment floor trunking

24-HOUR ACCESS

Card Key system incorporated with the passenger lifts for controlling access to each office floor after office hours

AIR-CONDITIONING

Variable Air Volume system (VAV) with Direct Digital Control (DDC) and perimeter heating

LIFTS

8 passenger lifts and 1 service lift

TENANTS' STANDBY ELECTRICAL PROVISION

A 600 kVA emergency generator is provided for tenants' essential applications and equipment

COMPUTER ROOM COOLING

Dedicated 24-hour chilled water supply with backup generator

TELECOMMUNICATIONS PROVISIONS

- Dual lead-ins and risers
- Full Cat.5 and fibre optic cabling
- Access to SMATV, cable TV and broadband Internet services
- Complete choice of FTNS operators
- Direct fibre connectivity to all other buildings in Taikoo Place and Cityplaza including data centres and global carriers
- Direct access to the Satellite Farm in Taikoo Place and Cityplaza

ACCESSIBLE CAR PARKING SPACES

Over 1,300

ENVIRONMENTAL RATING

BEAM (Building Environmental Assessment Method)
Rating: PLATINUM



CAMBRIDGE HOUSE

TAIKOO PLACE, 979 KING'S ROAD, QUARRY BAY,
HONG KONG

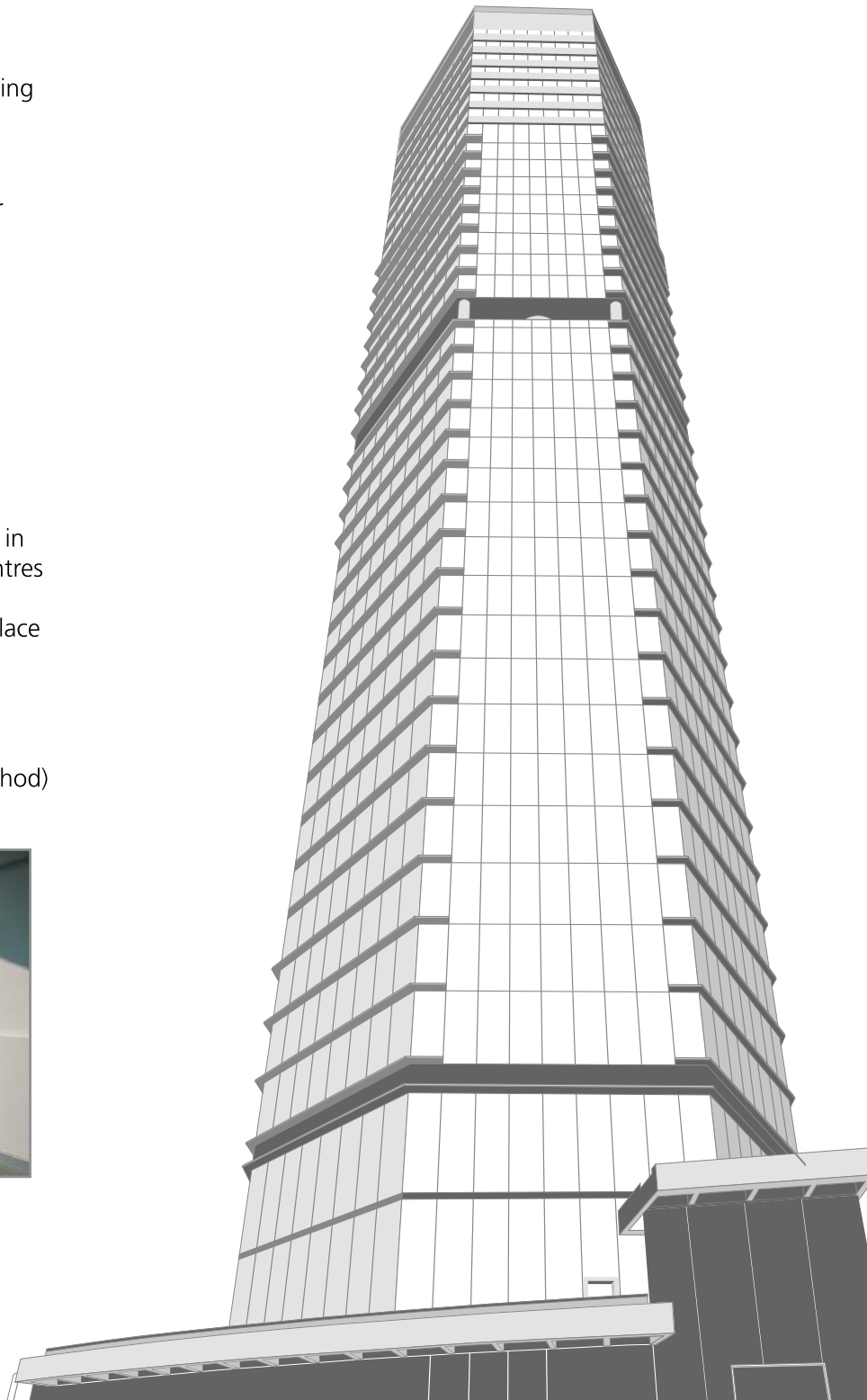
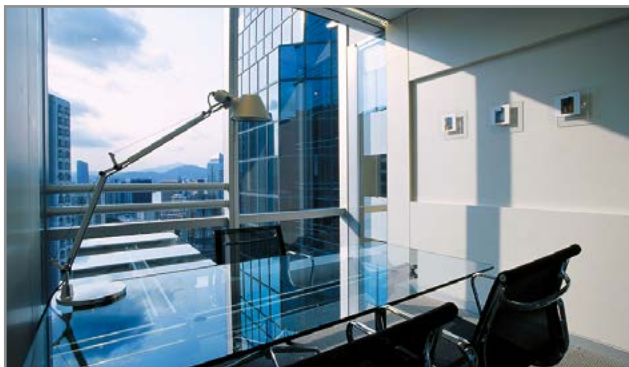

TYPICAL FLOOR PLAN

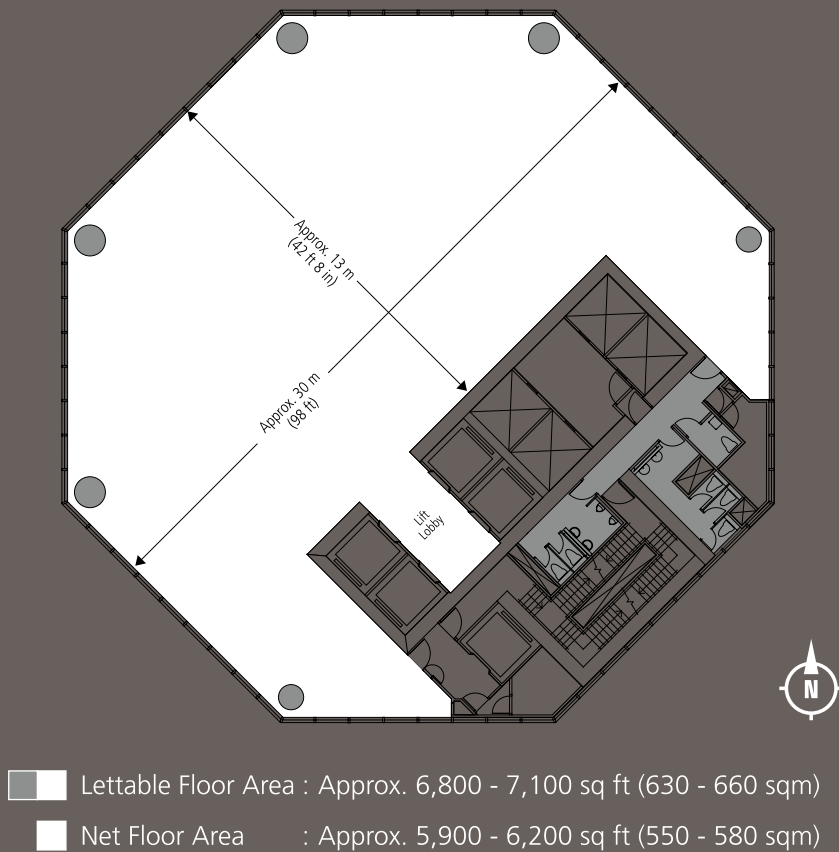

LOCATION MAP

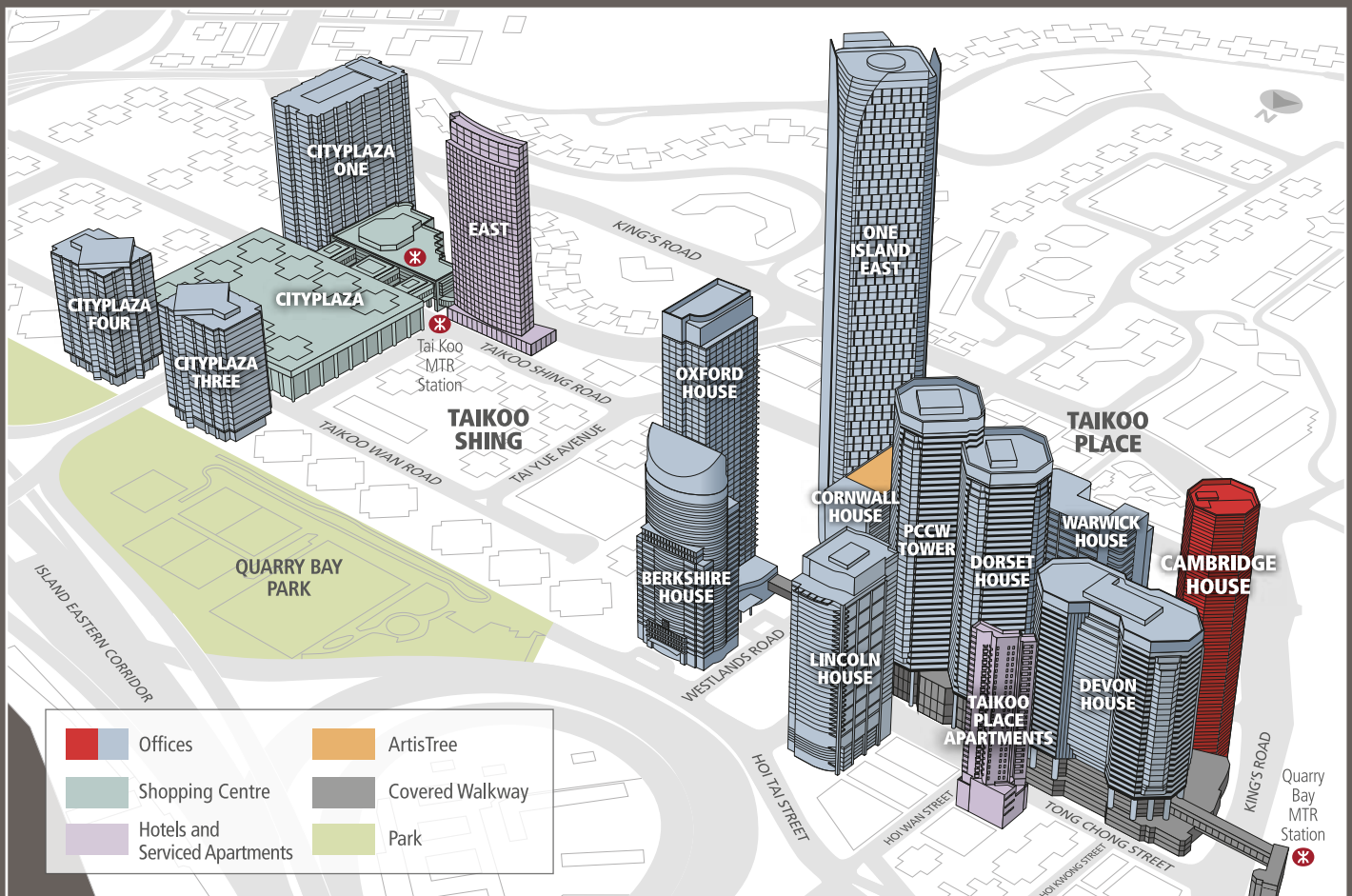

Disclaimer: Please note that all information contained in this document is correct at time of going to print. These are for your reference and identification only. There may be technical variations due to, amongst other reasons, site constraints which can only be verified on site. © Swire Properties Limited